

LT Rectilinear Displacement Transducer

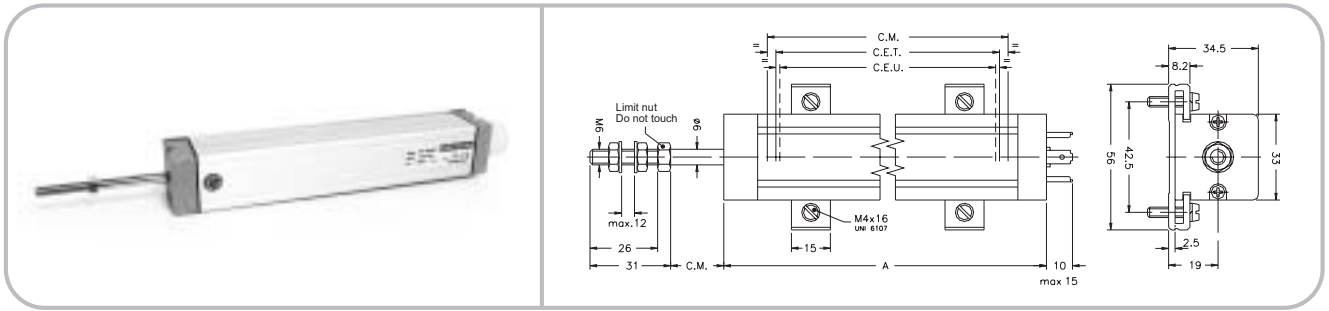

Order code



Connector output	
3 pole connector output	H
4 pole connector output DIN43650 ISO4400	M
5 pole connector output DIN43322	B
3 pole PVC cable output 3x0,25, tail length=1m	F

Stroke length (mm)	
50	100
130	150
175	200
225	275
300	375
400	450
500	600
750	900

Protection	
Standard version IP60	S
Version IP65	P

Example: **LT - M - 275 - S**
 Displacement transducer model LT, 4 pole connector output
 DIN 43650 - ISO 4400, useful electrical stroke (C.E.U.)
 275mm, standard version IP60.

Note: LT transducers are supplied complete with fixing kit

Electrical connections

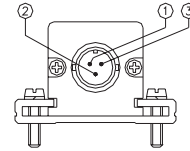

LT H output

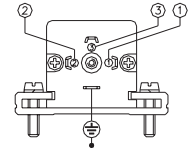

LT M output

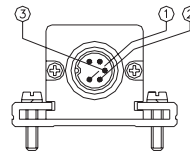

LT B output

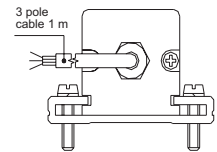

LT F output

Accessories

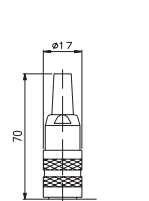

CON011 - IP40 Prot.
(DIN43322 5 pole
female connector)

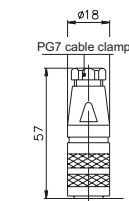

CON012 - IP67 Prot.
(DIN43322 5 pole
female connector)

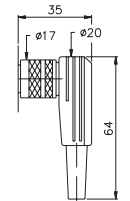

CON013 - IP40 Prot.
(DIN43322 5 pole
female connector)

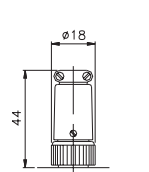

CON002 - IP40 Prot.
(4 pole female
connector)

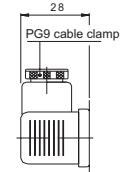

CON006 - IP65 Prot.
(DIN43650 4 pole
female connector)

Extraction length of the connector
 10mm. Coupling ball-joint - **PKIT015**

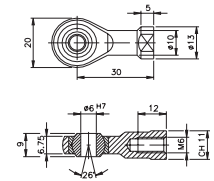

Mechanical / Electrical data

	50	100	130	150	175	200	225	275	300	375	400	450	500	600	750	900
Useful electrical stroke (C.E.U.) +3/-0 in mm	50	100	130	150	175	200	225	275	300	375	400	450	500	600	750	900
Resistance (C.E.T.) in kΩ	5	5	5	5	5	5	5	5	5	5	5	5	5	5	10	10
Mechanical stroke (C.M.) in mm	59	109	139	159	184	210	235	285	310	386	412	463	518	619	772	924
Case length in mm	113	163	193	213	234	264	289	339	364	440	466	517	572	673	826	978
Independant linearity (within C.E.U.)	±0.05%															
Displacement speed	Standard ≤ 10m/s															
Acceleration	200 m/s ²															
Maximum cursor current	10mA															
Maximum applicable voltage	60V															
Electrical isolation	>100MΩ at 500V=, 1bar, 2s															
Working temperature	-30...+100°C															
Protection level	IP65															