



Strip Heaters

for general industry



Strip heaters are used principally for clamp-on installations and also for convection-type air heating. Rugged, refractory insulated construction ensures long, dependable service. Strips are clamped longitudinally to large diameter cylindrical surfaces, to flat surfaces or mounted in ovens with insulating bushes. Mounting holes in tabs are slotted to allow expansion.

Maximum sheath temperature ranges from 650°C (chrome steel sheath) to 800°C (inconel sheath).

Applications



Utility clamps



Milled plate



Clamping bands



Oven mounting

Strip Elements

Standard stock items						
stock code	Power (Watts)	Length A (mm)	Pitch B (mm)	Height C (mm)	Supply (Volts)	Sheath material
UHF-T0702-129621	200	191	165	9.5	240	Chrome steel
UHF-T0802-129648	250	203	178	9.5	240	Chrome steel
UHF-T0804-129664	400	203	178	9.5	240	Chrome steel
UHF-T1003-129680	350	267	241	9.5	240	Chrome steel
UHF-T1004-129701	400	267	241	9.5	240	Chrome steel
UHF-T1202-129728	250	305	279	9.5	240	Chrome steel
UHF-T1203-129744	350	305	279	9.5	240	Chrome steel
UHF-T1205-129760	500	305	279	9.5	240	Chrome steel
UHF-T1405-129787	500	356	330	9.5	240	Chrome steel
UHF-T1505-129808	500	387	362	9.5	240	Chrome steel
UHF-T1805-129824	500	454	427	9.5	240	Chrome steel
UHF-T1807-129840	750	454	427	9.5	240	Chrome steel
UHF-T1801-129867	1000	454	427	9.5	240	Chrome steel
UHF-T1905-129883	500	495	470	9.5	240	Chrome steel
UHF-T1907-129904	750	495	470	9.5	240	Chrome steel
UHF-T1901-129920	1000	495	470	9.5	240	Chrome steel
UHF-T2107-129947	750	533	508	9.5	240	Chrome steel
UHF-T2405-129963	500	603	578	9.5	240	Chrome steel
UHF-T2407-129980	750	603	578	9.5	240	Chrome steel
UHF-T2401-130008	1000	603	578	9.5	240	Chrome steel
UHF-T2415-129234	1500	603	578	9.5	240	Chrome steel
UHF-T2507-121216	750	648	622	9.5	240	Chrome steel
UHF-T2501-121232	1000	648	622	9.5	240	Chrome steel
UHF-T2601-121259	1000	679	654	9.5	240	Chrome steel
UHF-T3007-121275	750	775	746	9.5	240	Chrome steel
UHF-T3001-121291	1000	775	746	9.5	240	Chrome steel
UHF-T3012-121304	1250	775	746	9.5	240	Chrome steel
UHF-T3307-121320	750	851	822	9.5	240	Chrome steel
UHF-T3601-121347	1500	911	883	9.5	240	Chrome steel
UHF-T3801-121363	1000	978	952	9.5	240	Chrome steel
UHF-T3815-121380	1500	978	952	9.5	240	Chrome steel
UHF-T4315-121400	1500	1080	1051	9.5	240	Chrome steel
UHF-T4813-121419	1350	1216	1187	9.5	240	Chrome steel
UHF-T4822-121427	2250	1216	1187	9.5	240	Chrome steel
Unitemp can supply other sizes and ratings						
Utility clamp:						
UHF-A-5971						
UHF-A-6933						

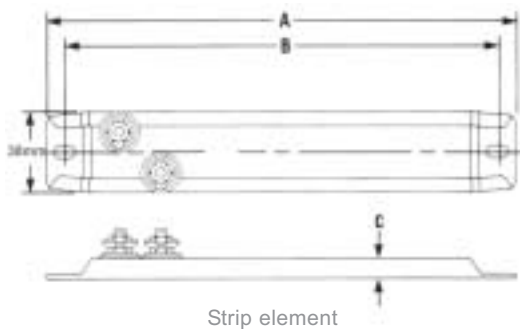

Strip element

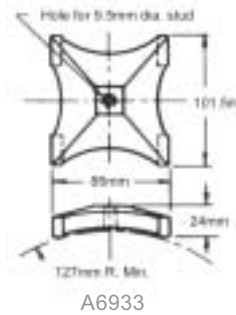

A6933

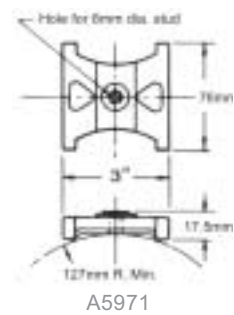

A5971

Utility clamps